

## PRODUCT INFORMATION OTICON CONNECTLINE STREAMER 1.4

*Streamer is the gateway to the ConnectLine system. ConnectLine empowers today's hearing instrument users to participate and interact in a number of everyday situations which can be difficult to manage, even with the best Hearing Instruments. The system includes specifically developed ConnectLine solutions for TV watching, landline phone (analog) use and a dedicated Partner/Companion Microphone. Streamer also supports Bluetooth connectivity for mobile phone headset functionality and other audio streaming capabilities.*

### **A fully integrated system**

With ConnectLine the user is in control of the system, not the other way around. Advanced features such as AutoPriority and AutoConnect ensure that, for example, a phone call can be heard and answered while watching TV. ConnectLine prioritizes wireless connections in a sensible and intuitive way.

### **Bluetooth technology**

Streamer has built-in Bluetooth technology and supports all relevant Bluetooth profiles. Bluetooth is a commonly used global standard for cell phones and offers a transmission range of up to 10 meters.

### **Ease of use**

The Streamer has been developed and thoroughly tested with hearing instrument users in mind, so that daily use is straightforward and intuitive.

### **Wireless headphones**

When a set of hearing instruments is linked to Streamer, audio can be transmitted directly and securely to both instruments from MP3 players or other audio devices.

### **Headset for cell phones**

Streamer can be paired to practically all modern cell phones, turning the hearing instruments into a high quality headset thanks to the built-in microphone in the top of the Streamer.

### **ConnectLine solutions**

Have all been developed specifically to meet the most important needs of hearing instrument users.

### **ConnectLine Phone Adaptor**

Makes Streamer compatible with land line (analog) phones, allowing Streamer to double as an extra wireless phone for calls at home.

### **ConnectLine TV Adaptor**

A dedicated solution for watching TV thanks to direct streaming of the sound from the TV to Streamer and the hearing instruments.

### **ConnectLine Microphone**

A small, discreet clip-on wireless microphone that improves the signal-to-noise ratio for the hearing instrument user in difficult listening situations.



## PRODUCT OVERVIEW

# Oticon | ConnectLine

### Included

- Neck straps (short and long)\*
- Power adapter for charging
- USB charger cord
- Audio cord, 1 meter (2.5 mm - 3.5 mm jack)
- Protective silicone skin

\* NOTE! The neck strap is part of the system, and should always be used for best possible performance.

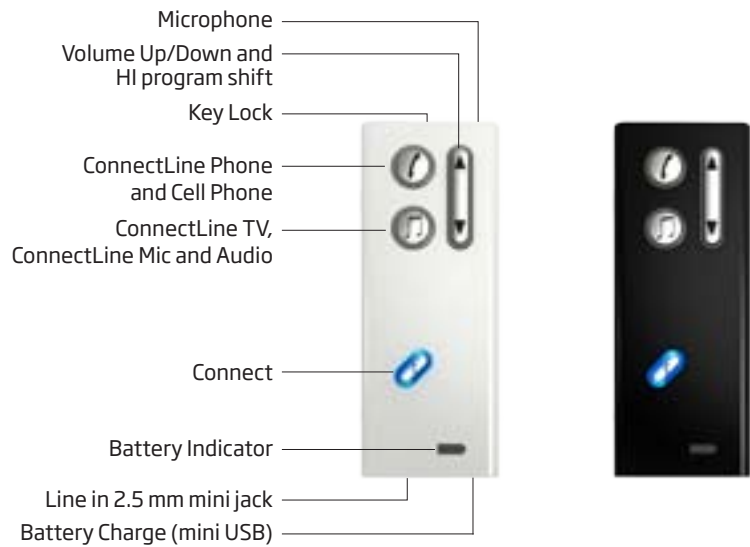

Technical data (firmware release 1.4)	
Dimensions	88 x 35 x 12 mm
Weight	43 g
Power supply	Built-in, rechargeable battery
Battery life	5 h streaming time 48 h stand-by (Connect on) 1 Year stand-by (Connect off) Charge time 5 h
AutoConnect	Yes (10 meter), two last connected phones
AutoPriority	Yes
ConnectLine solutions	ConnectLine Microphone ConnectLine Phone ConnectLine TV
No. of paired devices	8 at the same time
No. of connected devices	4 at the same time. 2 Phones, 1TV and 1 Microphone or 1 A2DP
Streaming frequency	3.84MHz
Line input sensitivity	400 mVrms (analogue)
Bluetooth compliance	Ver. 2.0
Bluetooth profile support	Advanced Audio Distribution Profile (A2DP) 1.0 Head Set Profile (HSP) 1.1 Hands Free Profile (HFP) 1.0
Bluetooth range	10 meters (Class 2)
EarStream range	0.5 meter nom. Neck strap should be used for best possible performance.
Audio Quality	Mono / 20 kHz sample frq
Audio Bandwidth	80 Hz - 10 kHz
Status indicators	LEDs on Streamer. Acoustic signals in hearing instruments.
Colors	Black or White
Emissions	Max. -15dBµA / 10 meters in compliance with all relevant standards
Operating temperature	10 - 45 °C
Storage temperature	-20 - 70 °C
Operating humidity	< 85% relative humidity. Note the protective skin should not be used in humid environments
Genie 2010.2 (or later)	Two Streamers can be connected to one set of hearing instruments, for more user benefits